

CLIENT.

NORTHANTS COUNTY COUNCIL

NOTES.

LOCATION PLAN COPIED UNDER LICENCE FROM ORDINANCE SURVEY PLAN. REF 100019078



REVISIONS

CONTRACTORS MUST CHECK ALL DIMENSIONS ON SITE AND NOTIFY ANY DISCREPANCIES FOUND.

PROJECT

**ALTERATIONS AND EXTENSIONS
GUILDSBOROUGH SECONDARY SCHOOL
NORTHANTS.**

DRAWING DESCRIPTION

LOCATION PLAN.

SCALE 1:1250

DRAWN K.J.L

DATE NOV. 06

DWG NO 1989.10

BHC

ARCHITECTS

28 CRANFORD TERRACE, HARBOUROUGH ROAD
KINGSTHORPE, NORTHAMPTON NN2 7AZ
TELEPHONE 01534 716700 FAX 01534 715504

ARCHITECTS SURVEYORS PROJECT MANAGERS

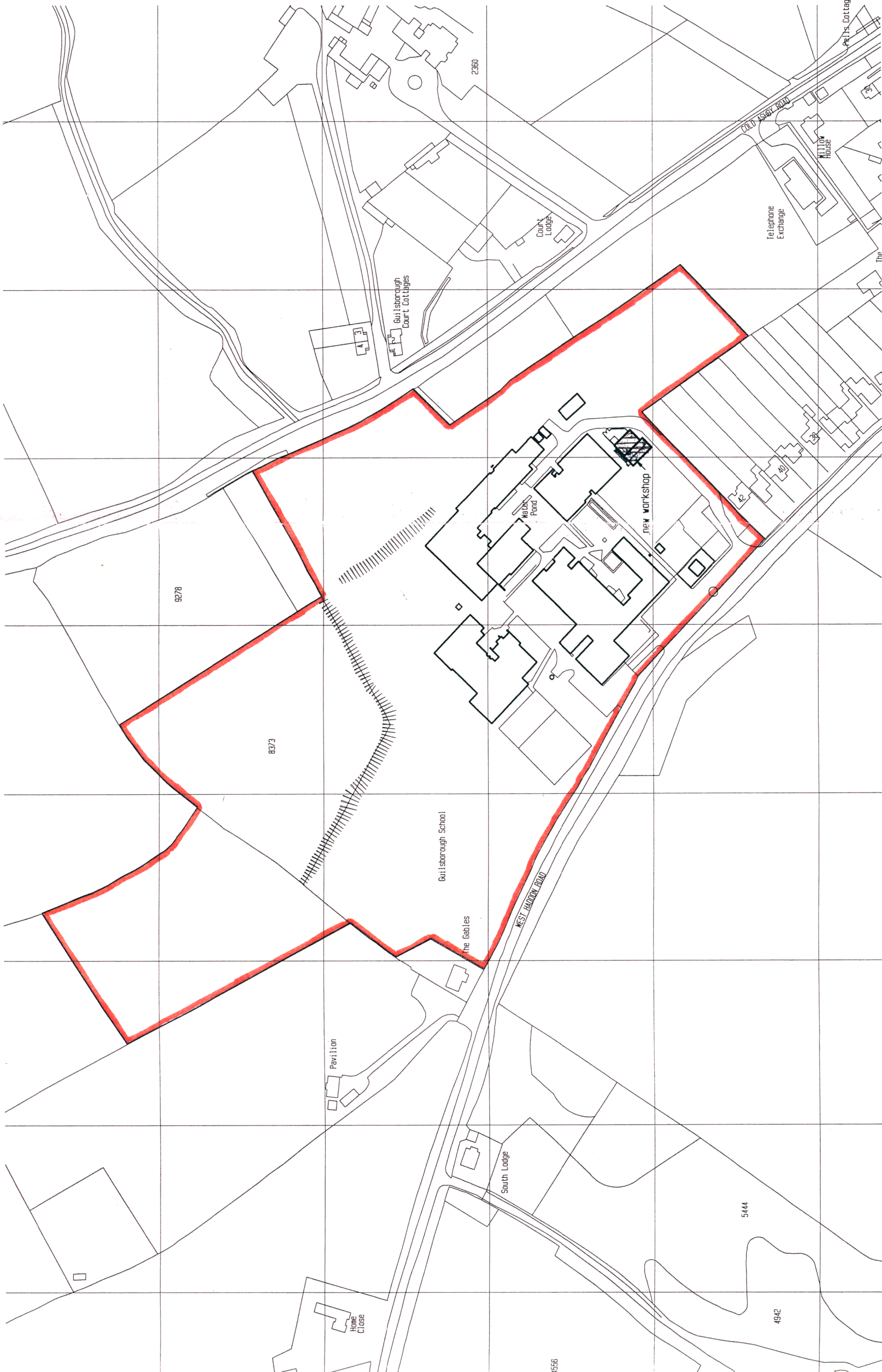

**NORTHAMPTONSHIRE
COUNTY COUNCIL**

11 DEC 2006

GROWTH MANAGEMENT