

Churchfield Farm Quarry Extension, at Oundle

Site Location Plan
GPP/PGR/CFQ/11/01

PGR Construction

Scale 1:25,000 at A4

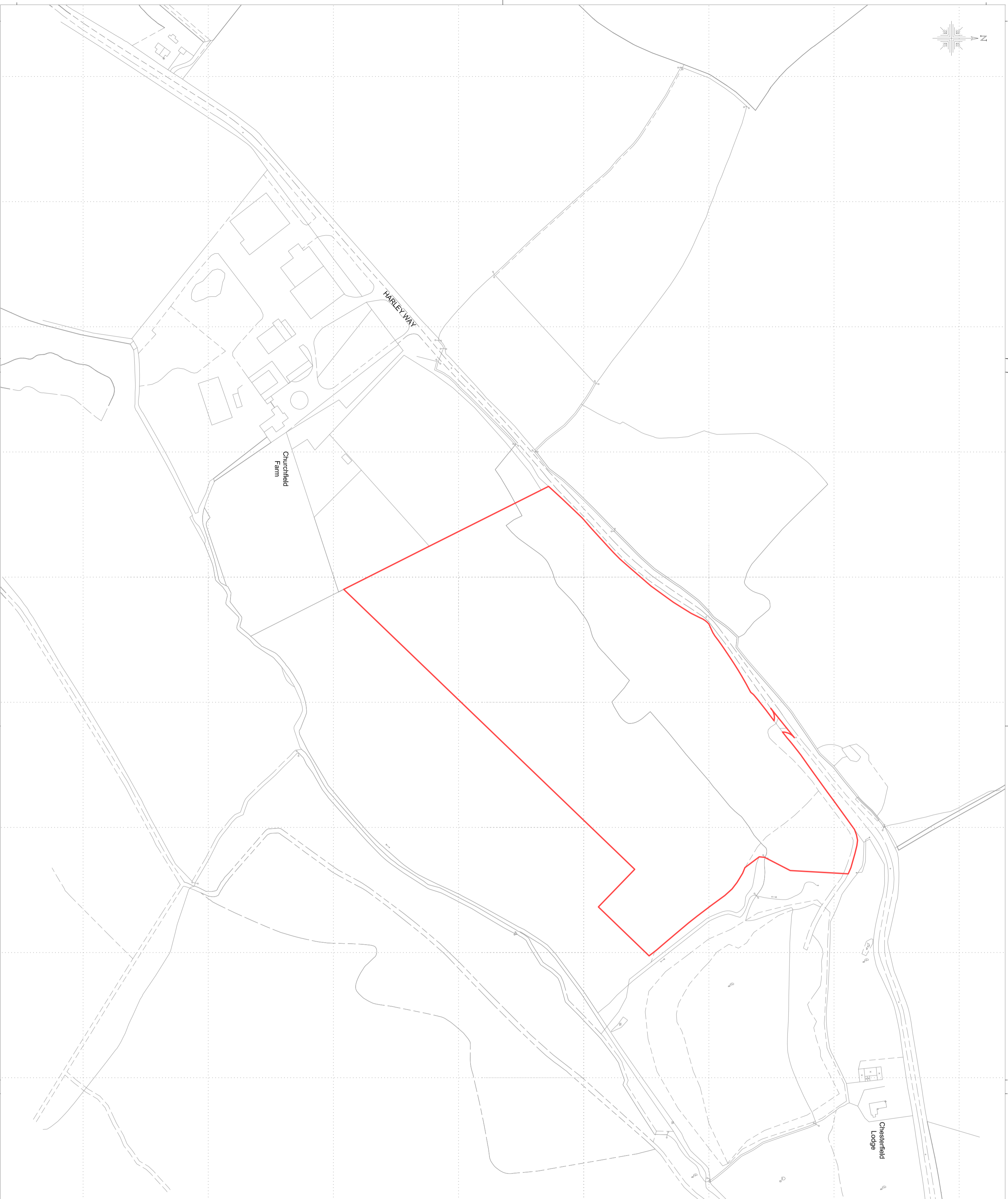
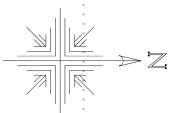

All drawings to be worked on site. If any discrepancies arise between the drawings and the site, the drawings shall prevail. Any areas indicated on this drawing are for guidance only. No responsibility is taken for their accuracy.
 This drawing is the property of GPP Planning Limited. Copyright is reserved by them and the drawing is based on the condition that it is not copied, reproduced, or otherwise used in any way without the written consent of GPP Planning Limited. All rights reserved.
 © 2011 GPP Planning Limited. All rights reserved.

Rev	Description	Issued	Date
2	Amendment to red line boundary	LB	30/06/11

GPP
 ENVIRONMENTAL CONSULTANTS
 Environmental Consultants
 Planning and Licensing
 T: 01924 771123 F: 01924 771028 E: info@gppplanning.co.uk
 The Studios, Long Lane, East London, Northamptonshire, NN8 8DU
 Registered in England No. 6019666

CLIENT:	Churchfield Stone Limited		
TITLE:	Harley Way Quarry at Oundle Site Plan		
DRAWN BY:	KD / LB	CHECKED BY:	LB / NM
DRAWING NO.:	GPP/CSHWQ/11/02	REV NO.:	2
SCALE:	1:2000 @ A2	DATE:	01 June 2011
SCALE BAR:			